



IP22

# MIP01

## SURFACE FLUORESCENT CORRIDOR LUMINARY

### APPLICATION AREA:

Corner luminary for use in passage ways, cabins, corridors lounges dinning rooms, accommodation areas.

### DESIGN:

According to the rules of international classification societies, VDE and IEC.

### HOUSING:

Zinc coated steel, powder coated RAL9010.  
Diffuser made of opal acrylic.

### LAMPS:

18/36 Watt T8.

### MOUNTING:

Three mounting holes 5.5 mm.

### ELECTRIC:

230V 50 or 60Hz,  
Flexible cable, heat resistant up to 105°C.

### CABLE ENTRY:

Four cable inlets 20mm.

### PROTECTION:

IP22

### OPTIONS:

Emergency E14 lampholder.

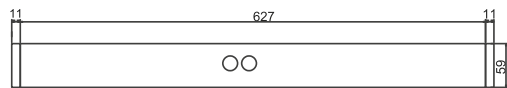
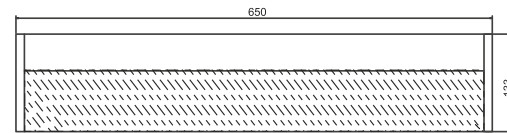
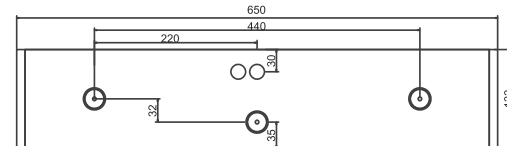

### ORDER CODES:

CODE	VOLTAGE	FREQUENCY	BALLAST	LAMP
MIP01 118-11	230V	50Hz	1 MAGNETIC WITH CAPACITOR	18W T8
MIP01 118-12	230V	60Hz	1 MAGNETIC WITH CAPACITOR	18W T8
MIP01 118-14	110V	60Hz	1 MAGNETIC WITH CAPACITOR	18W T8
MIP01 118-35	220-240V	50-60Hz	1 ELECTRONIC	18W T8
MIP01 136-11	230V	50Hz	1 MAGNETIC WITH CAPACITOR	36W T8
MIP01 136-12	230V	60Hz	1 MAGNETIC WITH CAPACITOR	36W T8
MIP01 136-14	110V	60Hz	1 MAGNETIC WITH CAPACITOR	36W T8
MIP01 136-35	220-240V	50-60Hz	1 ELECTRONIC	36W T8
MIP01 114-35	220-240V	50-60Hz	1 ELECTRONIC	14W T5
MIP01 124-35	220-240V	50-60Hz	1 ELECTRONIC	24W T5
MIP01 128-35	220-240V	50-60Hz	1 ELECTRONIC	28W T5
MIP01 135-35	220-240V	50-60Hz	1 ELECTRONIC	35W T5



# MIP02

IP22

## SURFACE LED CORRIDOR LUMINARY

### APPLICATION AREA:

Corner luminary for use in passage ways, cabins, corridors lounges dinning rooms, accommodation areas.

### DESIGN:

According to the rules of international classification societies, VDE and IEC.

### HOUSING:

Zinc coated steel, powder coated RAL9010.  
Diffuser made of opal acrylic.

### LAMPS:

LED Module.

### MOUNTING:

Three mounting holes 5.5 mm.

### ELECTRIC:

230V 50 or 60Hz,  
Flexible cable, heat resistant up to 105°C.

### CABLE ENTRY:

Four cable inlets 20mm.

### PROTECTION:

IP22

### OPTIONS:

Emergency E14 lampholder.

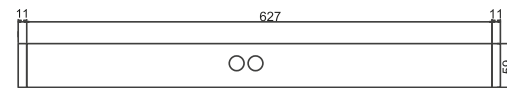
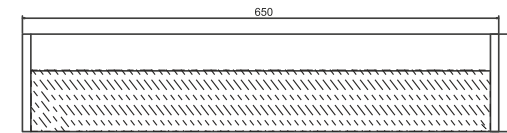
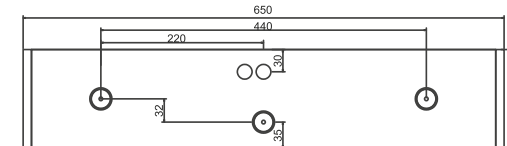

### ORDER CODES:

CODE	WATTAGE	VOLTAGE	FREQUENCY
MIP02 LED-56	10W	220-240V	50-60Hz
MIP02 LED-112	20W	220-240V	50-60Hz

